

Seven Seas Mariner® DECK PLANS

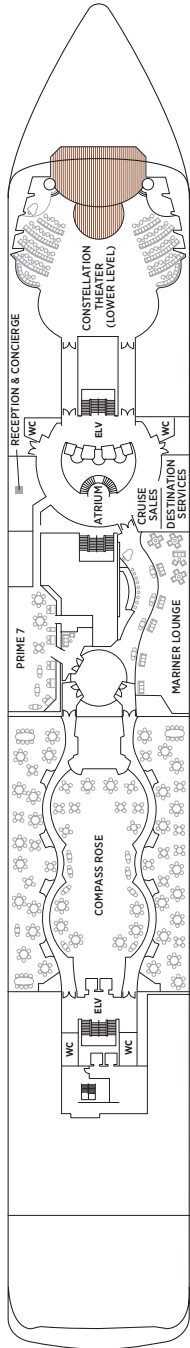

DECK 5

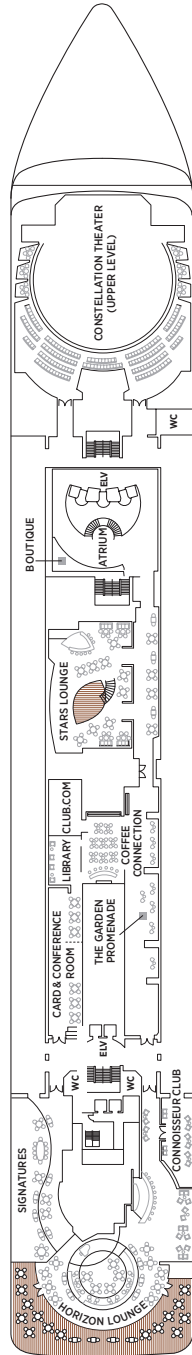

DECK 6

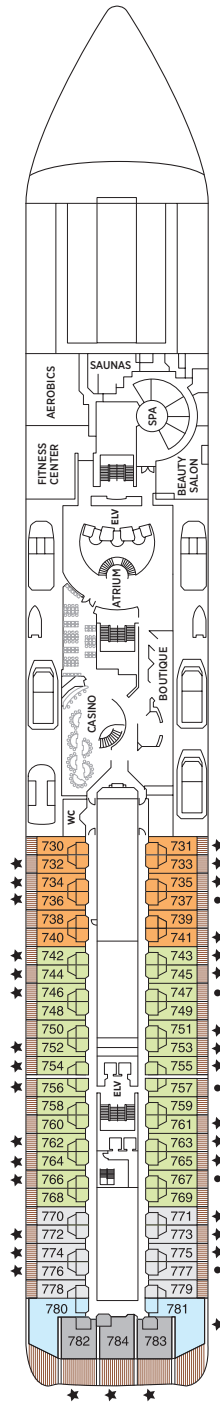

DECK 7

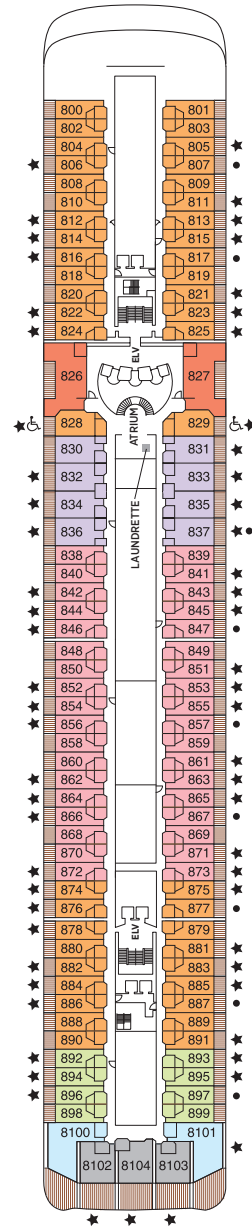

DECK 8

- | | |
|--|---|
| MS MASTER SUITE | C PENTHOUSE SUITE |
| GS GRAND SUITE | D CONCIERGE SUITE |
| MN MARINER SUITE | E CONCIERGE SUITE |
| SS SEVEN SEAS SUITE | F DELUXE VERANDA SUITE |
| HS HORIZON VIEW SUITE | G DELUXE VERANDA SUITE |
| A PENTHOUSE SUITE | H DELUXE VERANDA SUITE |
| B PENTHOUSE SUITE | |

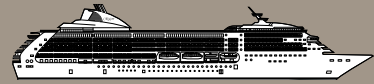

OVERALL LENGTH 709 ft.
 BEAM (WIDTH) 93 ft.
 DRAFT 21 ft.
 GUESTS 700
 OFFICERS European
 CREW 445 European/International
 GUEST DECKS 8
 GROSS TONNAGE 48,075
 CRUISING SPEED 20 Knots
 SHIP'S REGISTRY Bahamas

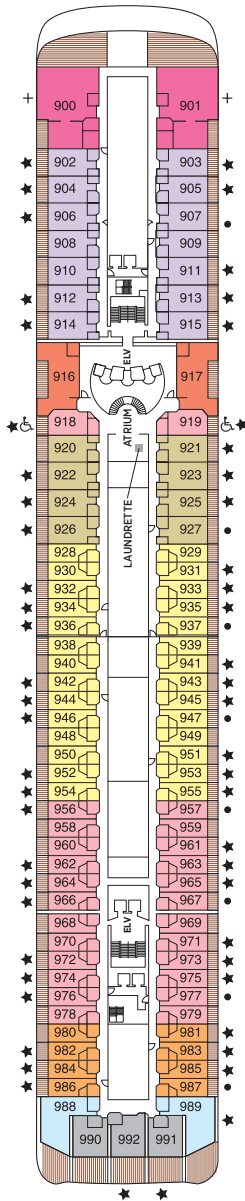

DECK 9

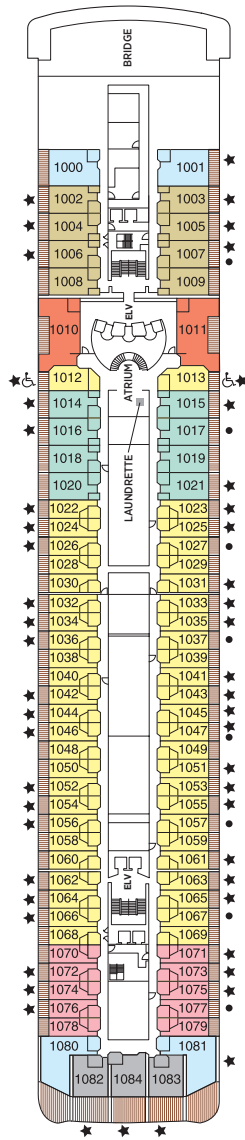

DECK 10

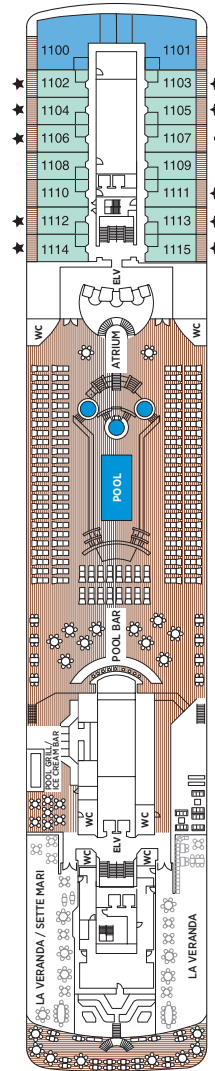

DECK 11

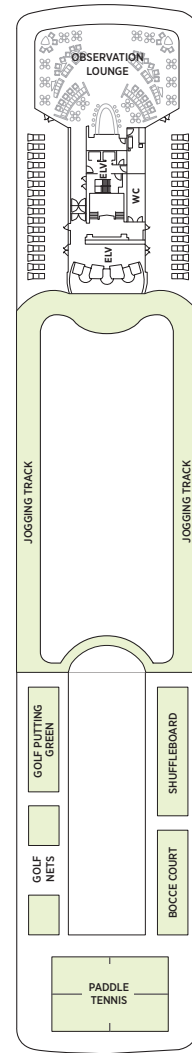

DECK 12

- + 2-bedroom suite accommodates up to 6 guests
- Convertible sofa bed
- ♿ Wheelchair accessible suites 828, 829, 918, 919, 1012 and 1013 have shower stall instead of bathtub
- ★ Bathroom features a glass-enclosed shower instead of bathtub

Up to one rollaway bed can be added to most staterooms, please inquire at time of booking.